

Window Intercom

SD-2006DL+



Features

**Duplex Intercom**

SD-2006V+ supports two-way intercom inside and outside the window.

**Clear sound | Volume adjustment**

The voice is clear, natural and loud. That support the sound inside and outside the window, and the volume can be adjusted

**Auto-mute**

SD-2006DL+ supports infrared detection function and can enter into mute mode automatically.

**Easy to Use**

Plug and Play, Easy installation, support desktop placement or wall mounted.
Power adapter(DC12V/200mA)

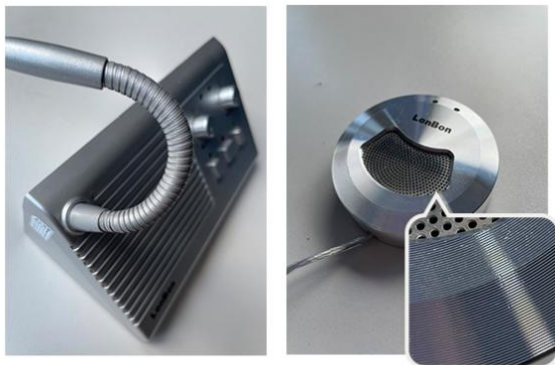

- The External Speaker adopts all aluminum alloy shell and built-in infrared induction probe.
- Stainless steel hose microphone tube can be folded without any dead angle.

Technical Specifications

Host speaker impedance power:	8 Ω , 1.5W
Extension speaker impedance power:	8 Ω , 1.2W
Host microphone sensitivity:	-51 \pm 2dB
Output frequency	20Hz~20KHz
Sensitivity of extension microphone:	-44 \pm 2dB
Signal to noise ratio:	\geq 90dB
Harmonic distortion:	< 0.5%
Working temperature:	-20 $^{\circ}$ C ~ + 60 $^{\circ}$ C
Working humidity:	10% - 90%
Host size:	80x150x55mm
Extension size:	ϕ 64x18mm
Host microphone length:	360mm
Cable length	1.9m (Distance from host to extension)
Material	Plastic (Host station) Aluminum alloy (Extension station)

Interface Connection

- 1** Counter Intercom Control (Host)
 - Volume control button
 - Counter MIC switch
 - Indicator light
- 2** External Speaker Control (Sub)
 - Volume control button
 - Counter MIC switch
 - Indicator light
- 3** OUT
Connection jack of External Speaker (Sub).
- 4** MIC.
Internal MIC 3.5mm jack.
- 5** REC.
Record, monitor and interjection 3.5mm jack.
- 6** POWER
Power jack for power supply DC12V / 0.2A.

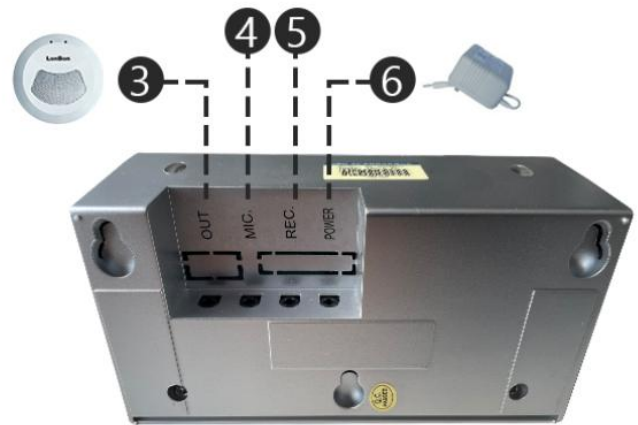

Package Includes



1 x Dual-way counter intercom

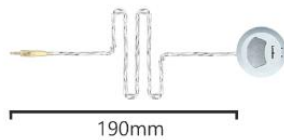

1 x External speaker

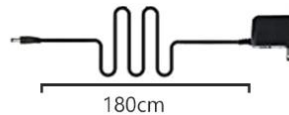

1 x Power adapter with cable



1 x English manual