

IPX8 Waterproof Button with Pull cord Emergency Push

NBW-AN3



Features

Waterproof design, 3-core BUS, online coding mode; wall mounted installation in the emergency room, can be used for patients to alarm in case of emergency.

Alarm mode: support pull rope and button alarm.

Waterproof performance: IPX8 waterproof grade, supporting direct use under the shower.

Alarm prompt: after the alarm, the ring indicator light is on and accompanied by a prompt sound.

Connection mode: 3-core bus connection.

Technical parameters

Bus protocol : FSK, DTMF	Work temperature : -20℃ ~ +80℃
Waterproof level : IPX8	Working humidity : 10% ~ 99%
Cord pull length : 0.6m	Power : 0.1W
Work voltage : 12V~24V	Installation height : 0.6m
Dimension : 86x86x11.5mm(LxWxH)	
Package dimension : 620x395x555mm(LxWxH); Package : 74units/carton	

How to Connection

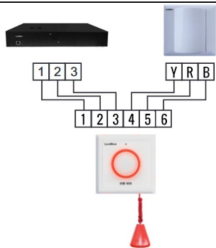
	1. White -> BUS-1	
	2. Black -> BUS-2	
	3. Yellow -> BUS-3	
	4. Yellow -> Lamp(Yellow)	
	5. Red -> Lamp(Red)	
	6. Black -> Lamp(Black)	

How to Installation

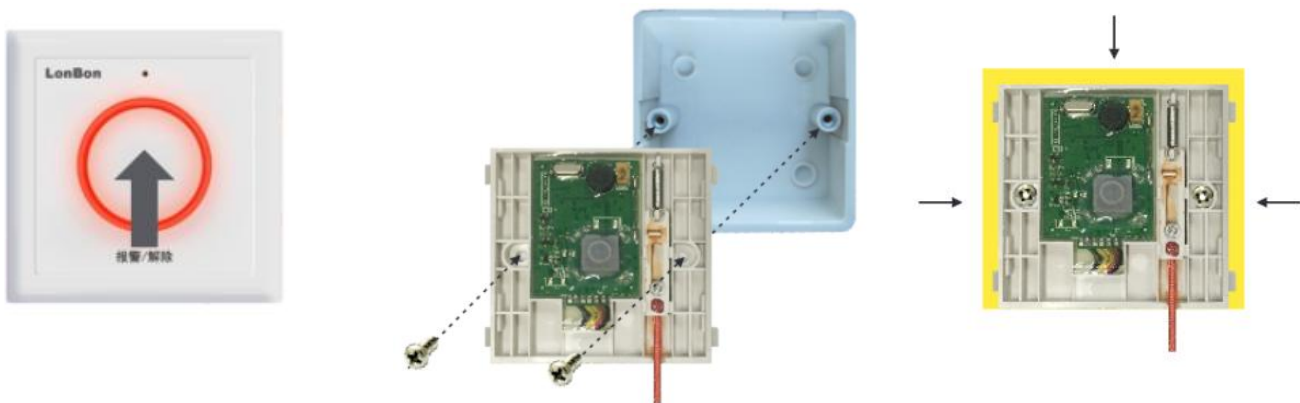

Step 1. Take the lower cover and press the middle ring button with both hands, turn up the green edge of the cover, and take down the cover.

Step 2. Fix the bottom cover, screw the bottom cover of the button onto the embedded 86 box, tighten the screws properly, and then test the smoothness of pulling rope.

Step 3. Glue the upper, left and right sides of the bottom cover with water-proof glue to avoid water inside the equipment to accelerate the aging of the line; ensure that the long-term pulling of the cable causes the equipment to move, and finally fasten the cover.

Note: over tightening of screws may cause deformation of cover and affect normal use.